

DO NOT SCALE

A2

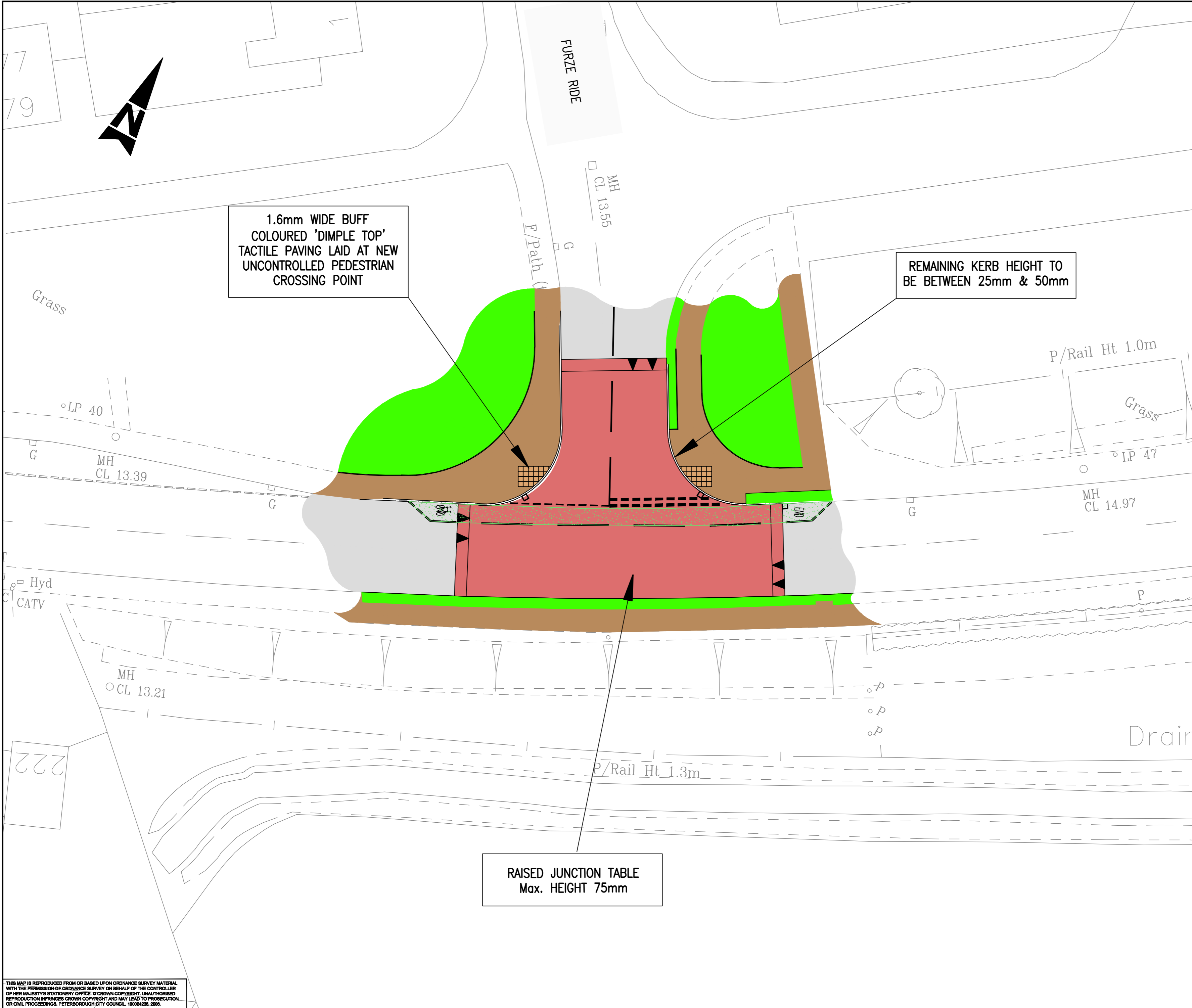

1.6m WIDE BUFF COLOURED 'DIMPLE TOP' TACTILE PAVING LAID AT NEW UNCONTROLLED PEDESTRIAN CROSSING POINT

REMAINING KERB HEIGHT TO BE BETWEEN 25mm & 50mm

RAISED JUNCTION TABLE  
 Max. HEIGHT 75mm

KEY  
 PLEASE NOTE THAT THE COLOURS SHOWN ON THIS PLAN ARE INDICATIVE ONLY AND AREA NOT NECESSARILY REPRESENTATIVE OF THE COLOURS OF THE MATERIALS TO BE USED

- FOOTWAY SURFACING
- CARRIAGEWAY SURFACING
- GRASS AREA
- BUFF COLOURED TACTILE PAVING
- RED COLOURED TACTILE PAVING
- BUFF COLOURED ANTI SKID SURFACE
- GREEN COLOURED SURFACE DRESSING

P	A	FOR EXHIBITION	10/08	TW
Stat	Rev	Purpose of Issue	Date	Auth
A	FIRST ISSUE	CET	10/08	RC TW
Rev	Description	By	Date	Chk'd Auth

**Atkins Limited**  
 Consulting Engineers,  
 Broad Oak, Southgate Park,  
 Bakewell Road, Orton Southgate,  
 Peterborough, Cambridgeshire  
 England, PE2 6YS.  
 Tel: (01733) 366900  
 Fax: (01733) 366999  
 www.atkinsglobal.com

Client  
**PETERBOROUGH CITY COUNCIL**

Project  
**A1073 TRAFFIC MITIGATION**

Title  
**WELLAND ROAD TRAFFIC CALMING  
 RAISED TABLE AT FURZE RIDE  
 GENERAL ARRANGEMENT**

Sheet Size	Original Scale	Designed/Drawn	Checked	Authorised
<b>A2</b>	<b>1:200</b>	Date 10/08	Date 10/08	Date 10/08
Status	Drawing Number			Rev
<b>P</b>	<b>EX_5063605/HW/PD/0116</b>			<b>A</b>

THIS MAP IS REPRODUCED FROM OR BASED UPON ORDNANCE SURVEY MATERIAL WITH THE PERMISSION OF ORDNANCE SURVEY ON BEHALF OF THE CONTROLLER OF HER MAJESTY'S STATIONERY OFFICE. © CROWN COPYRIGHT. UNAUTHORISED REPRODUCTION INFRINGES CROWN COPYRIGHT AND MAY LEAD TO PROSECUTION OR CIVIL PROCEEDINGS. PETERBOROUGH CITY COUNCIL. 100294298. 2008.